

18.40.430 Open space

18.40.431 Guidelines

- (1) In multi-family residential developments, common open space areas should be easily accessible from all buildings with the maximum number of units sited adjacent to the common open space areas. In addition to the common open space areas, projects are encouraged to provide each unit with usable private open space. These private spaces should be directly accessible from the unit and large enough to permit outdoor living activities.

18.40.432 Standards

- (1) Open space areas shall be provided and maintained as a percentage of the lot equal to or greater than 40% for multiple household projects.

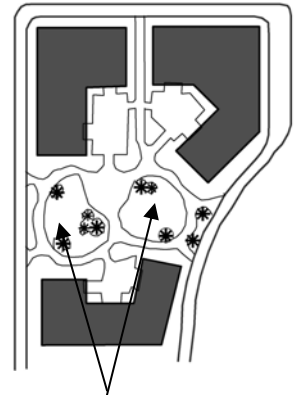

Private open space